



Prices start from
£70,000

for a 40% share* of
a 2 bedroom house

**No stamp duty for
first time buyers**

Quantock View

Cotford St Luke

The properties are located on the edge of Cotford St Luke a popular village which is surrounded by stunning open countryside and sits at the foot of the Quantock Hills

The village of Cotford St Luke offers a good range of facilities including a Co-operative store with a post office, pub/restaurant, pre-school, primary school, village hall and playing fields.

The prices are correct at the time of print but can be subject to change, speak to a Sales Consultant for further details.
The floor plans shown are for guidance only and are subject to change during construction. Window and door positions may vary from home to home, and some homes may be left or right handed.

*Eligibility criteria. Terms and conditions apply. Prices are subject to change and are based on a 40% share of a 2 bedroom house.
Speak to our Sales Consultants for further details.

Contact us for more information

Telephone: 01934 526 446
Email: newhomes@livewest.co.uk

LiveWest
A home for everyone

LiveWest
A home for everyone

Site plan

Plots 24 & 25
2 bedroom house

LiveWest rent



Floor plan

Plots
24 & 25
2 Bedroom House

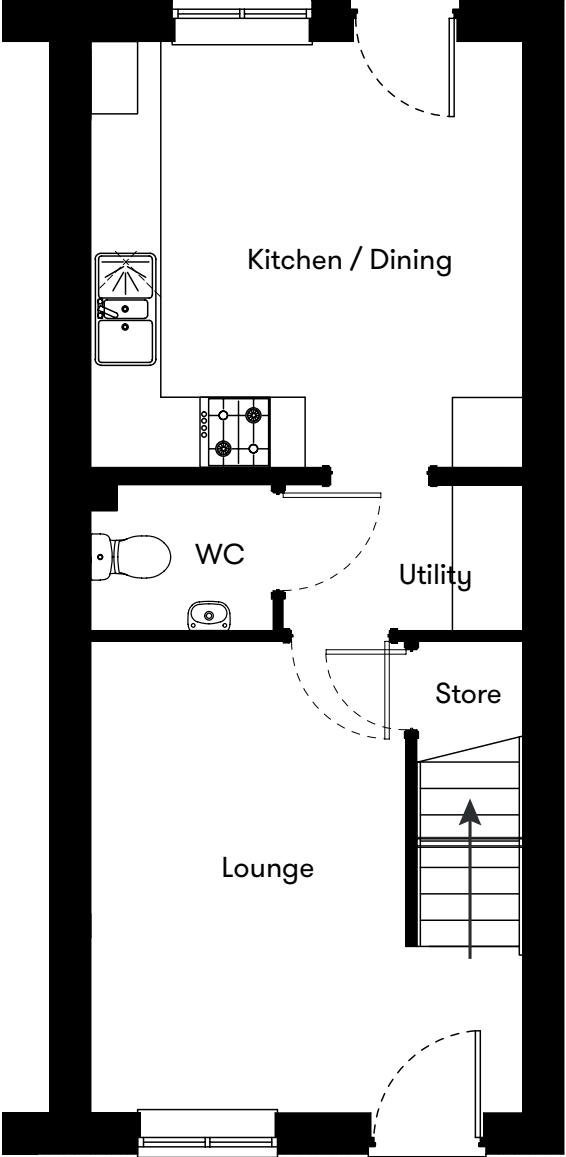

Ground Floor

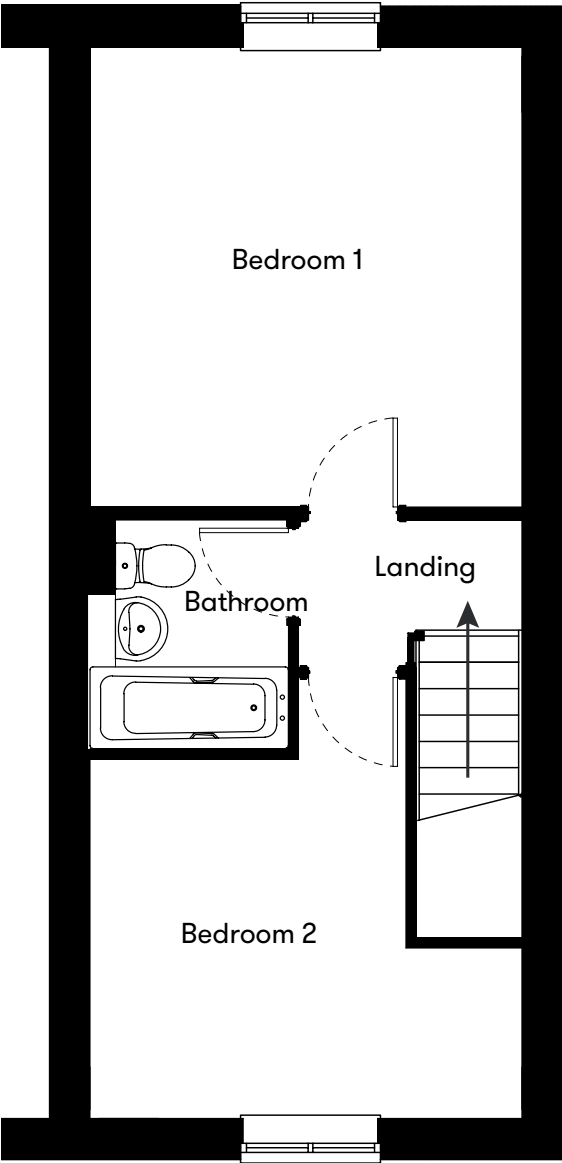

First Floor

Plot	House type	Open Market Value	40% Share	Monthly Charge
24	2 bedroom semi detached house with 2 parking spaces	-	-	RESERVED
25	2 bedroom semi detached house with 2 parking spaces	£175,000	£70,000	£225.75

*Including rent, buildings insurance. Service charge to be confirmed.

Contact us for more information

Telephone: 01934 526 446
Email: newhomes@livewest.co.uk



Contact us for more information

Telephone: 01934 526 446
Email: newhomes@livewest.co.uk

