



Price start from
£84,600
for a 40% share* of
a 2 bedroom home
**No stamp duty for
first time buyers**

Nansledan

Newquay

LiveWest are offering local people a wonderful opportunity to purchase one of three new 2 bedroom shared ownership homes in the popular seaside town of Newquay.

Nansledan, meaning “Broad Valley” in Cornish, is less than 10 minutes by car to Newquay’s diverse Town Centre. Voted The Best Seaside Town by Which? Holidays, the area boasts many beaches - a haven for surfers, in addition to the local family attractions nearby.

The prices are correct at the time of print but can be subject to change, speak to a Sales Consultant for further details. The floor plans shown are for guidance only and are subject to change during construction. Window and door positions may vary from home to home, and some homes may be left or right handed. Please note that the carpets are not included as standard.

*Eligibility criteria. Terms and conditions apply. Prices are subject to change and are based on a 40% share of a 2 bedroom house. Speak to our Sales Consultants for further details.

Contact us for more information

Telephone: 01752 856037
Email: newhomes@livewest.co.uk



Site plan

Plots 286, 287 & 288
2 bedroom house

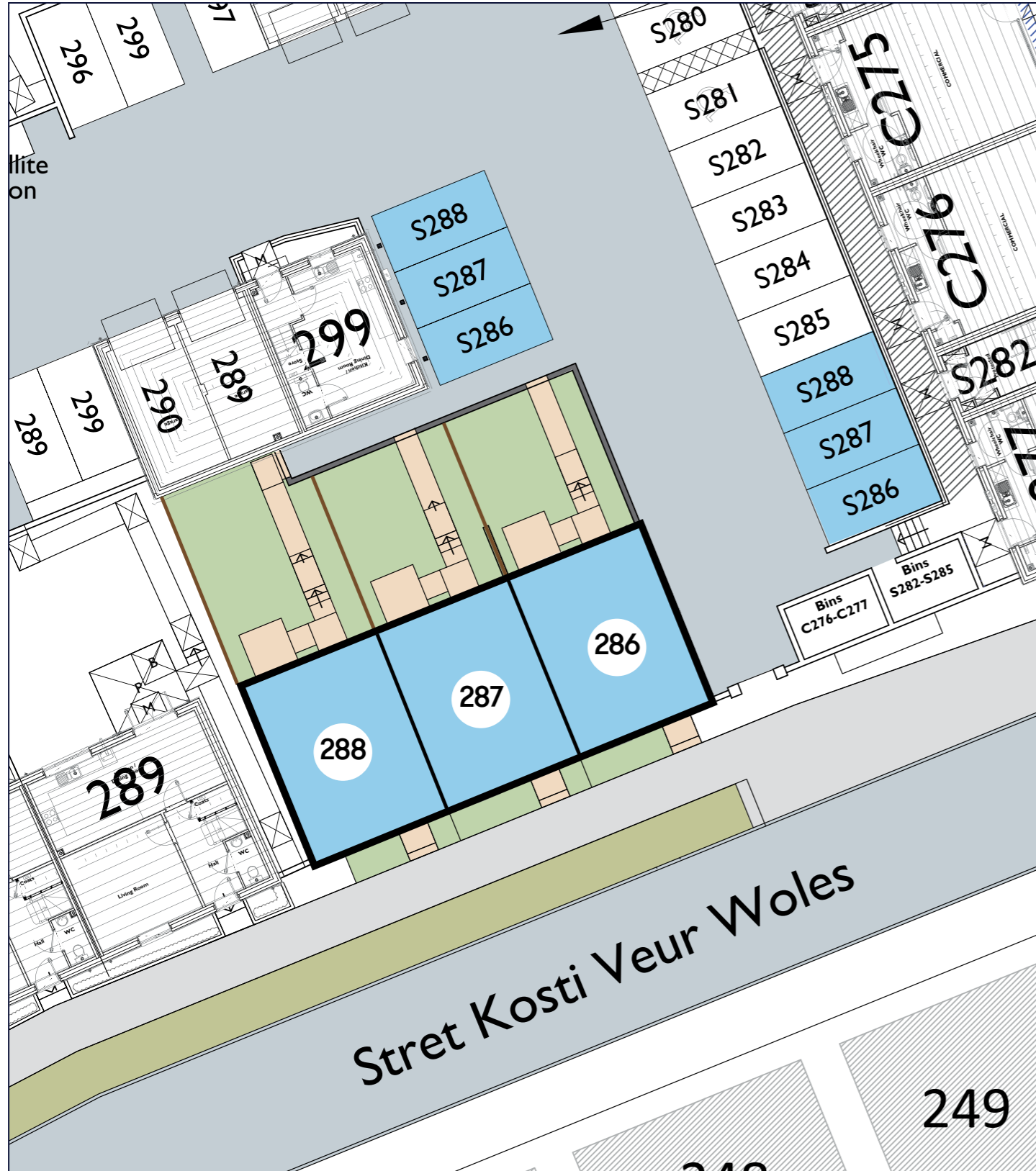

Floor plan

Plots
286, 287
& 288
2 Bedroom Homes

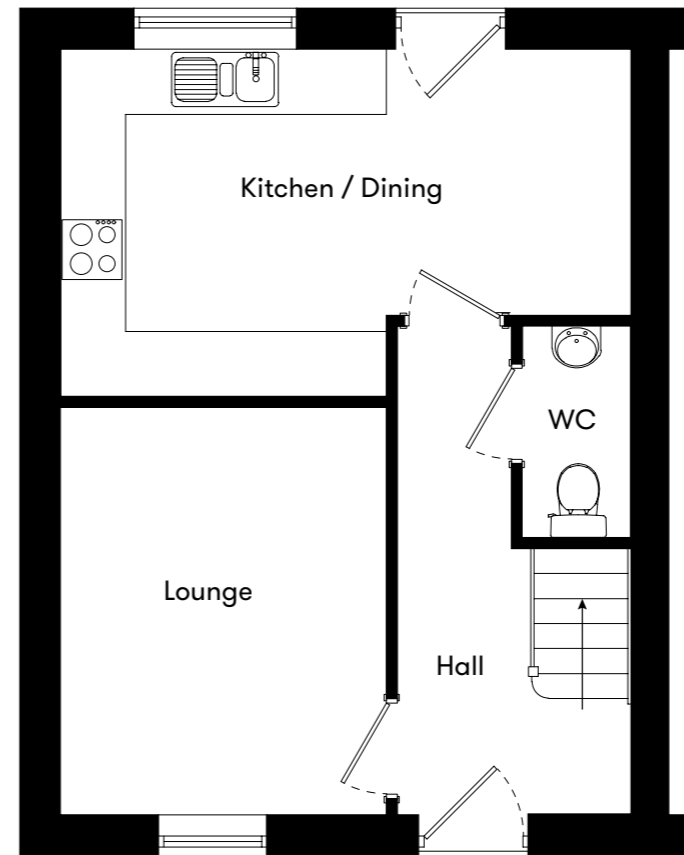

Ground Floor

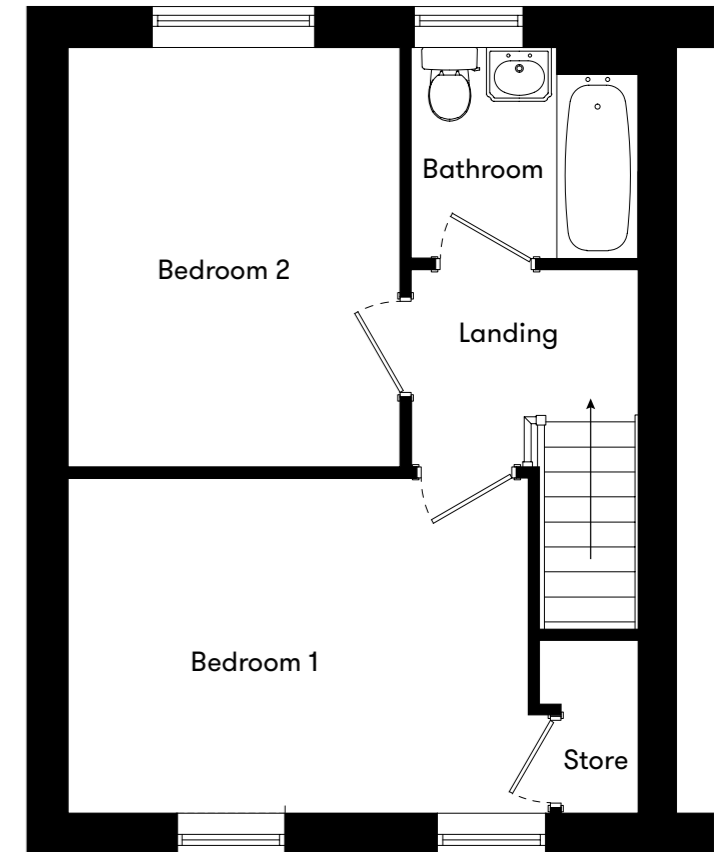

First Floor

Plot	House type	Open Market Value	40% Share	Monthly Charge
286	2 bedroom end terrace house with 2 parking spaces	£214,000	£85,600	£303.25
287	2 bedroom mid terrace house with 2 parking spaces	£211,500	£84,600	£300.13
288	2 bedroom end terrace house with 2 parking spaces	£216,500	£86,600	£306.38

*Monthly rent including buildings insurance and Service Charge.

Contact us for more information

Telephone: 01752 856037
Email: newhomes@livewest.co.uk



Contact us for more information

Telephone: 01752 856037
Email: newhomes@livewest.co.uk

